

DC EXHIBIT E

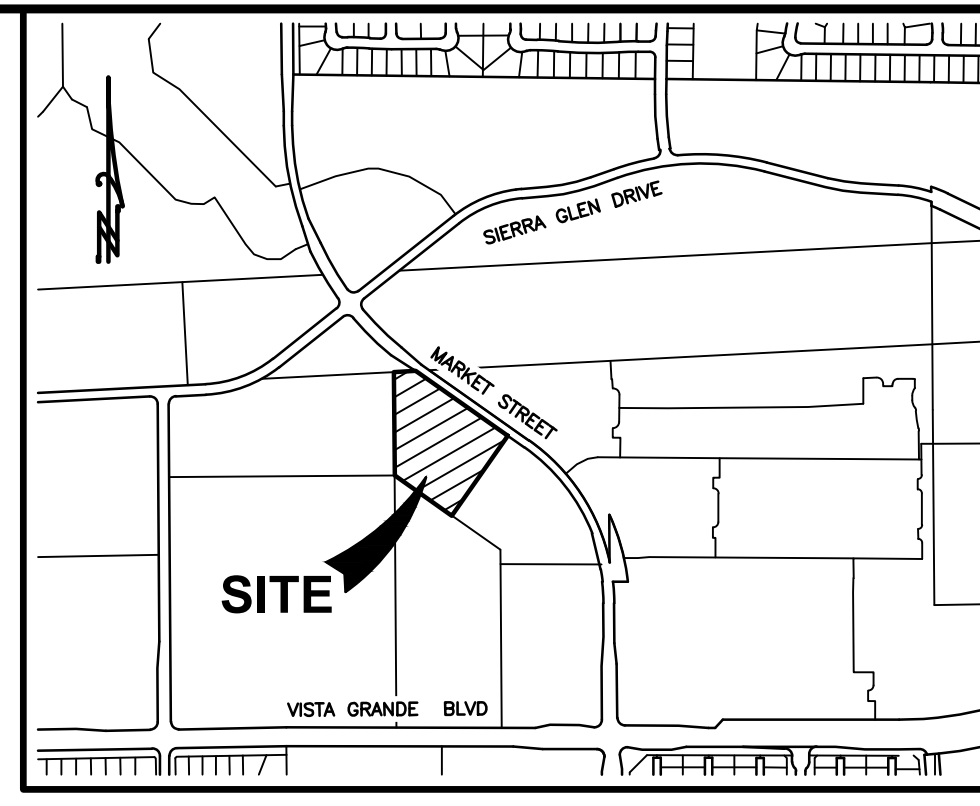
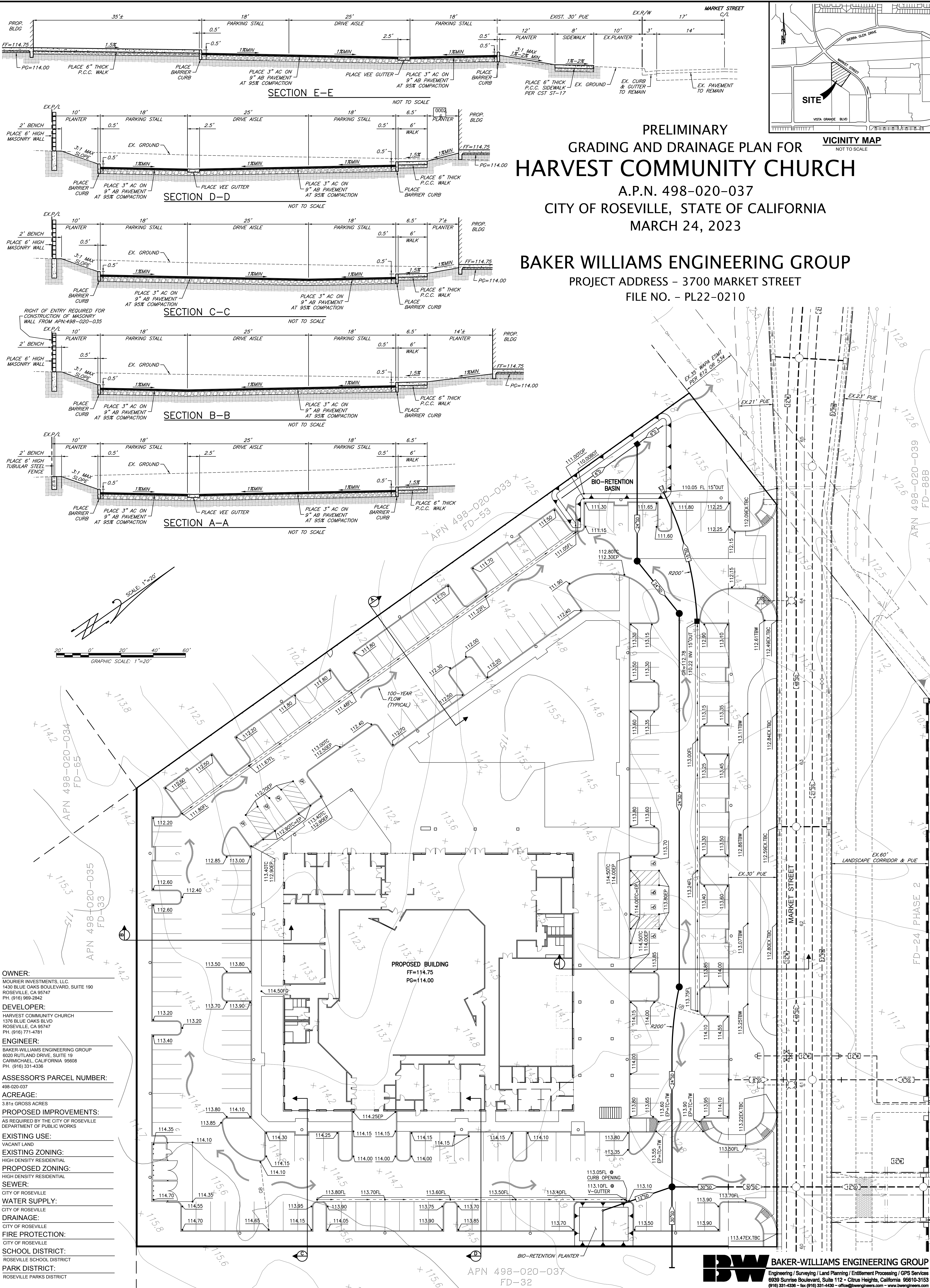

PRELIMINARY GRADING AND DRAINAGE PLAN FOR HARVEST COMMUNITY CHURCH

A.P.N. 498-020-037
CITY OF ROSEVILLE, STATE OF CALIFORNIA
MARCH 24, 2023

BAKER WILLIAMS ENGINEERING GROUP
PROJECT ADDRESS - 3700 MARKET STREET
FILE NO. - PL22-0210

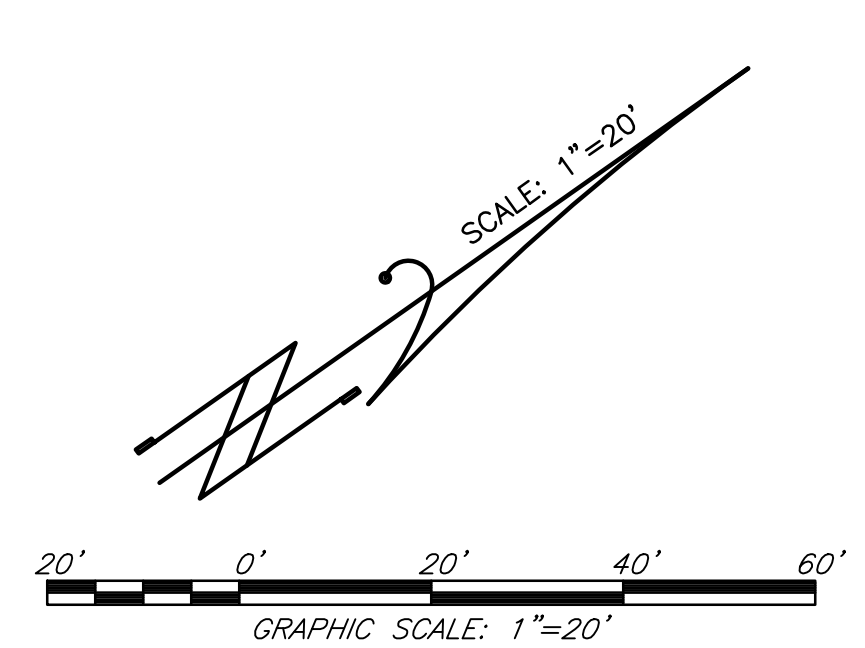
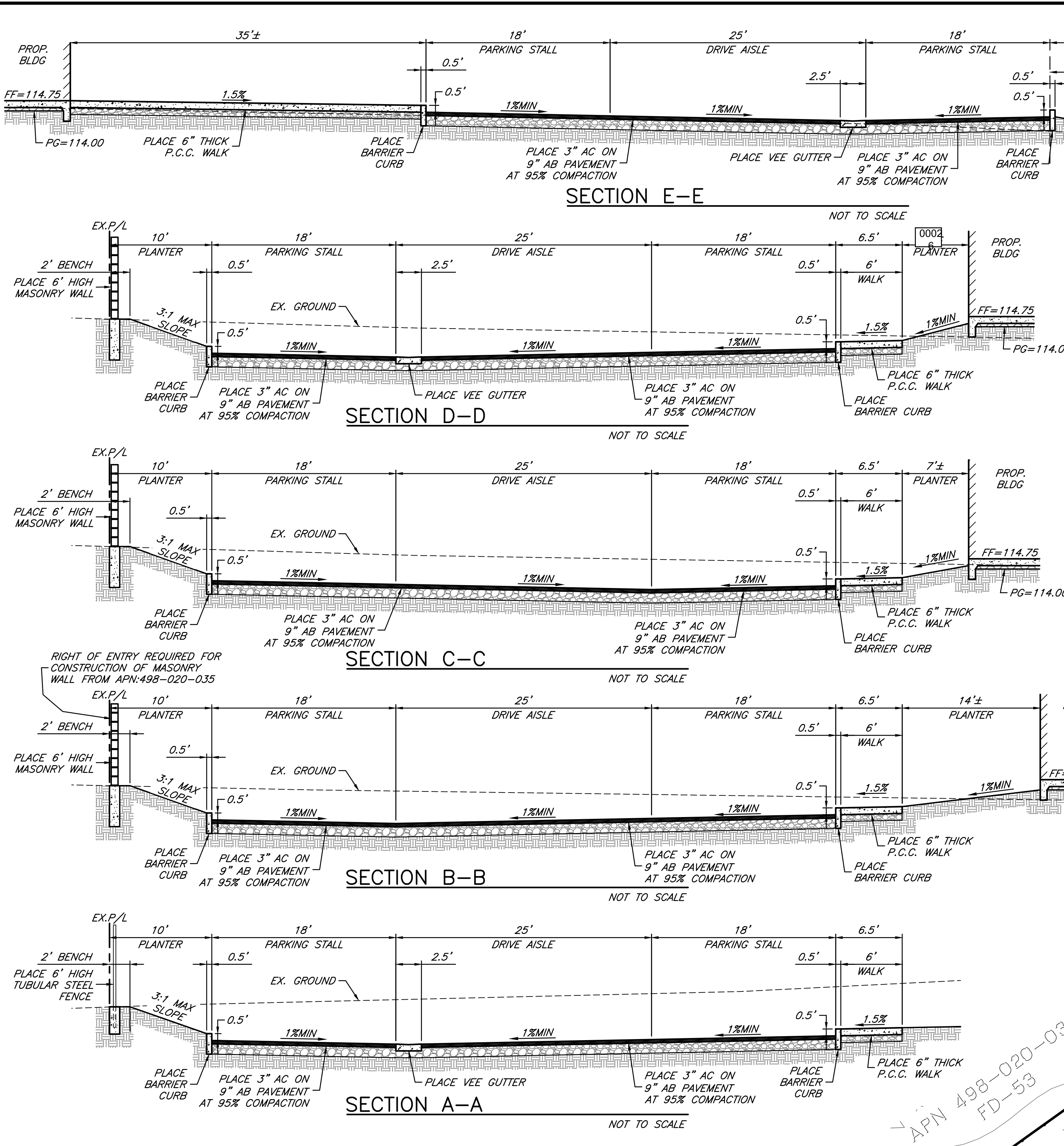

OWNER:
MOURIER INVESTMENTS, LLC
1430 BLUE OAKS BOULEVARD, SUITE 190
ROSEVILLE, CA 95747
PH. (916) 969-2842

DEVELOPER:
HARVEST COMMUNITY CHURCH
1376 BLUE OAKS BLVD
ROSEVILLE, CA 95747
PH. (916) 771-4781

ENGINEER:
BAKER WILLIAMS ENGINEERING GROUP
6020 RUTLAND DRIVE, SUITE 19
CARMICHAEL, CALIFORNIA 95608
PH. (916) 331-4336

ASSESSOR'S PARCEL NUMBER:
498-020-037

ACREAGE:
3.81+ GROSS ACRES

PROPOSED IMPROVEMENTS:
AS REQUIRED BY THE CITY OF ROSEVILLE
DEPARTMENT OF PUBLIC WORKS

EXISTING USE:
VACANT LAND

EXISTING ZONING:
HIGH DENSITY RESIDENTIAL

PROPOSED ZONING:
HIGH DENSITY RESIDENTIAL

SEWER:
CITY OF ROSEVILLE

WATER SUPPLY:
CITY OF ROSEVILLE

DRAINAGE:
CITY OF ROSEVILLE

FIRE PROTECTION:
CITY OF ROSEVILLE

SCHOOL DISTRICT:
ROSEVILLE SCHOOL DISTRICT

PARK DISTRICT:
ROSEVILLE PARKS DISTRICT

IBW BAKER WILLIAMS ENGINEERING GROUP
Engineering / Surveying / Land Planning / Entitlement Processing / GPS Services
6639 Sunrise Boulevard, Suite 112 • Citrus Heights, California 95610-3153
(916) 331-4336 • fax (916) 331-4430 • office@bwiengineers.com • www.bwiengineers.com

PRELIMINARY UTILITY PLAN FOR HARVEST COMMUNITY CHURCH

A.P.N. 498-020-037
CITY OF ROSEVILLE, STATE OF CALIFORNIA
MARCH 24, 2023

BAKER WILLIAMS ENGINEERING GROUP

PROJECT ADDRESS - 3700 MARKET STREET
FILE NO. - PL22-0210

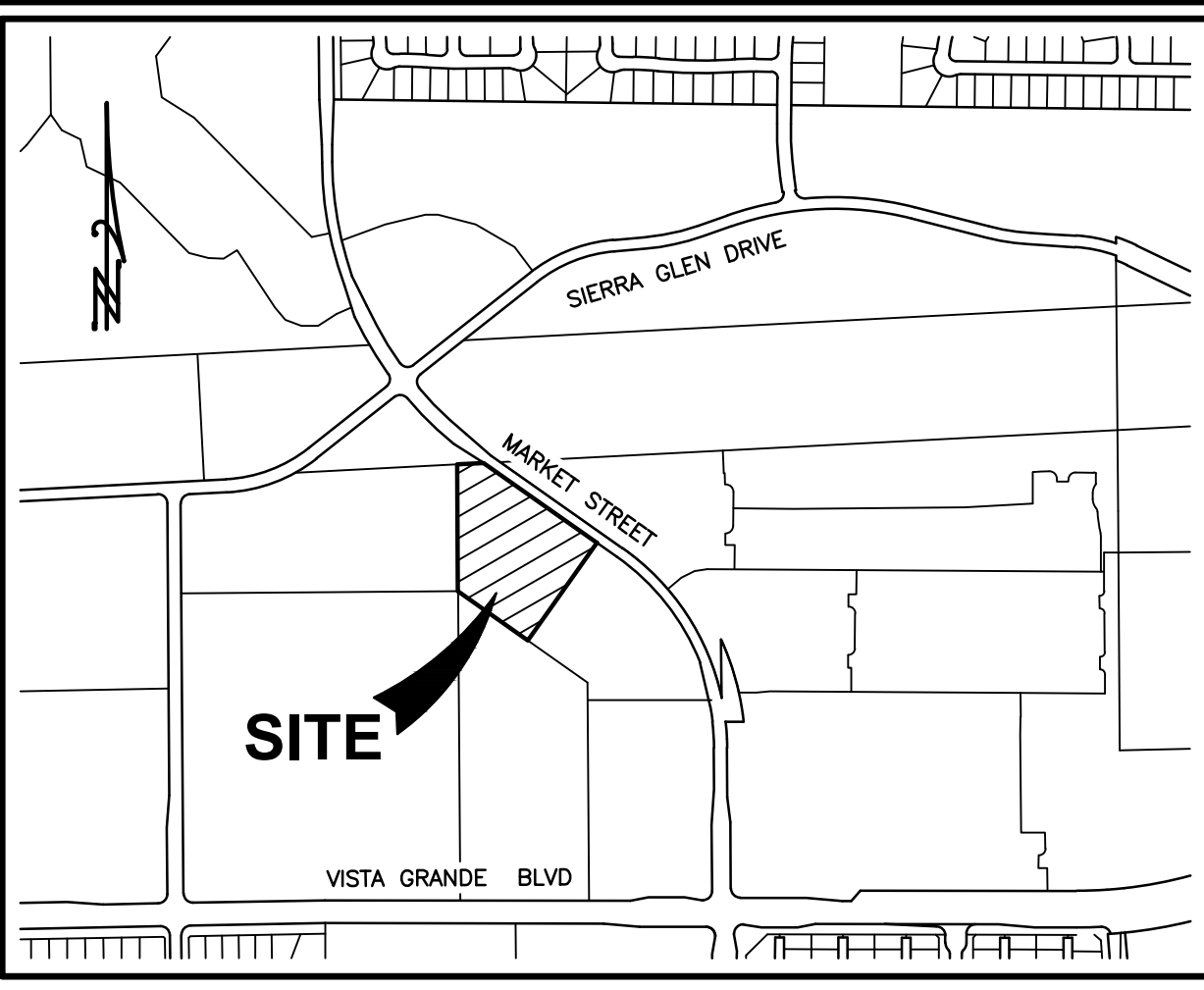

VICINITY MAP
NOT TO SCALE

OWNER:

MOURIER INVESTMENTS, LLC.
1430 BLUE OAKS BOULEVARD, SUITE 100
ROSEVILLE, CA 95747
PH. (916) 969-2842

DEVELOPER:

HARVEST COMMUNITY CHURCH
1376 BLUE OAKS BLVD
ROSEVILLE, CA 95747
PH. (916) 771-4781

ENGINEER:

BAKER WILLIAMS ENGINEERING GROUP
6020 RUTLAND DRIVE, SUITE 19
CARMICHAEL, CALIFORNIA 95608
PH. (916) 331-4336

ASSESSOR'S PARCEL NUMBER:

498-020-037

ACREAGE:

3.81+ GROSS ACRES

PROPOSED IMPROVEMENTS:

AS REQUIRED BY THE CITY OF ROSEVILLE
DEPARTMENT OF PUBLIC WORKS

EXISTING USE:

VACANT LAND

EXISTING ZONING:

HIGH DENSITY RESIDENTIAL

PROPOSED ZONING:

HIGH DENSITY RESIDENTIAL

SEWER:

CITY OF ROSEVILLE

WATER SUPPLY:

CITY OF ROSEVILLE

DRAINAGE:

CITY OF ROSEVILLE

FIRE PROTECTION:

CITY OF ROSEVILLE

SCHOOL DISTRICT:

ROSEVILLE SCHOOL DISTRICT

PARK DISTRICT:

ROSEVILLE PARKS DISTRICT

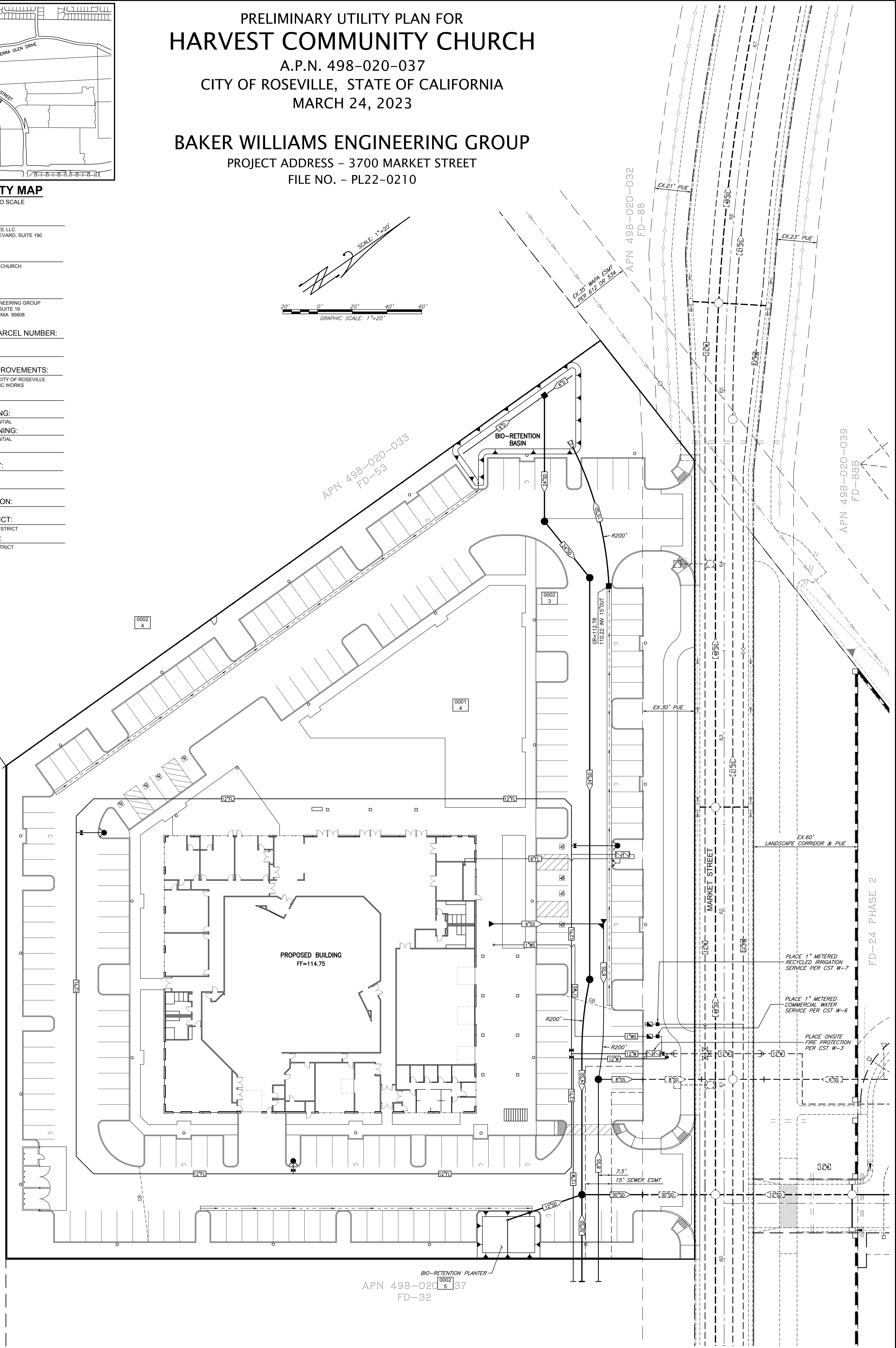
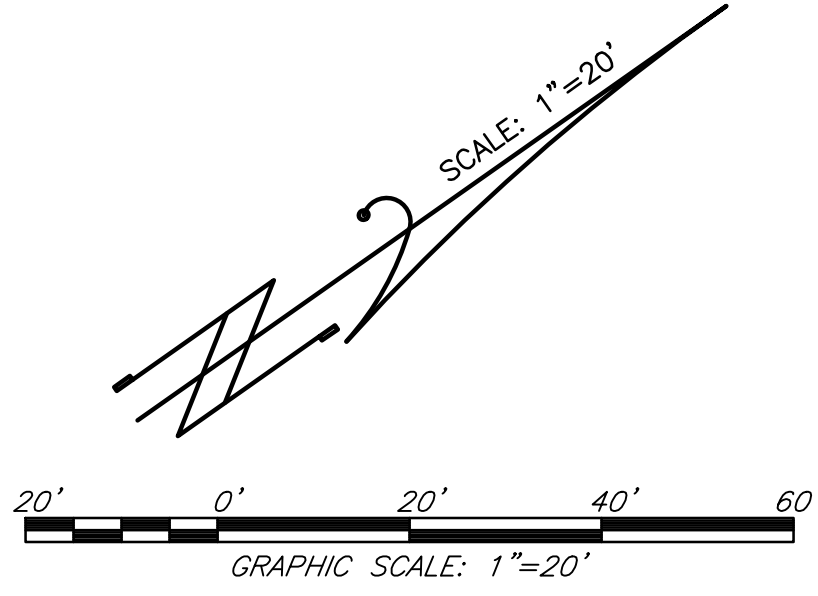

APN 498-020-037
FD-32